

## Easy Painted Doormats

online  
extra!

On the following pages, you'll find templates and step-by-step instructions to create these doormat projects for your home. For more information about these projects, see the May/June 2011 issue of *My Home My Style*.



## Make the Stencils & Apply the Paint

STEP  
BY  
step



1

**Adhere the printed pattern** to the sticky side of the contact paper, and then cut out the owl and the letters (*Inset Photo*).



2

**Spray stencil adhesive** on the back of each letter and pattern piece, and press them onto the mat in the proper positions.



3

**After rolling on two coats** of paint, take off the outer eye circles. Then use a stencil brush to dab paint in those areas.



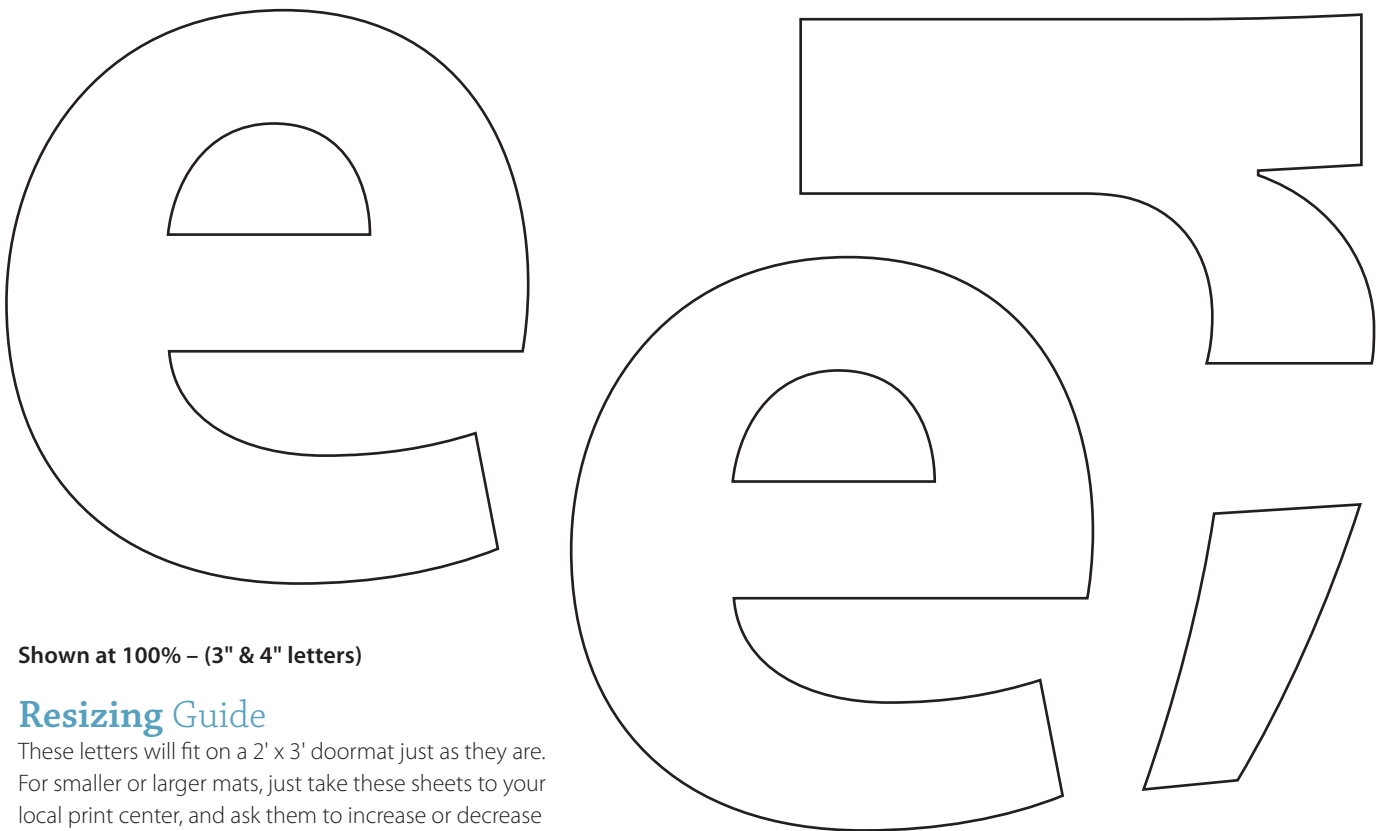
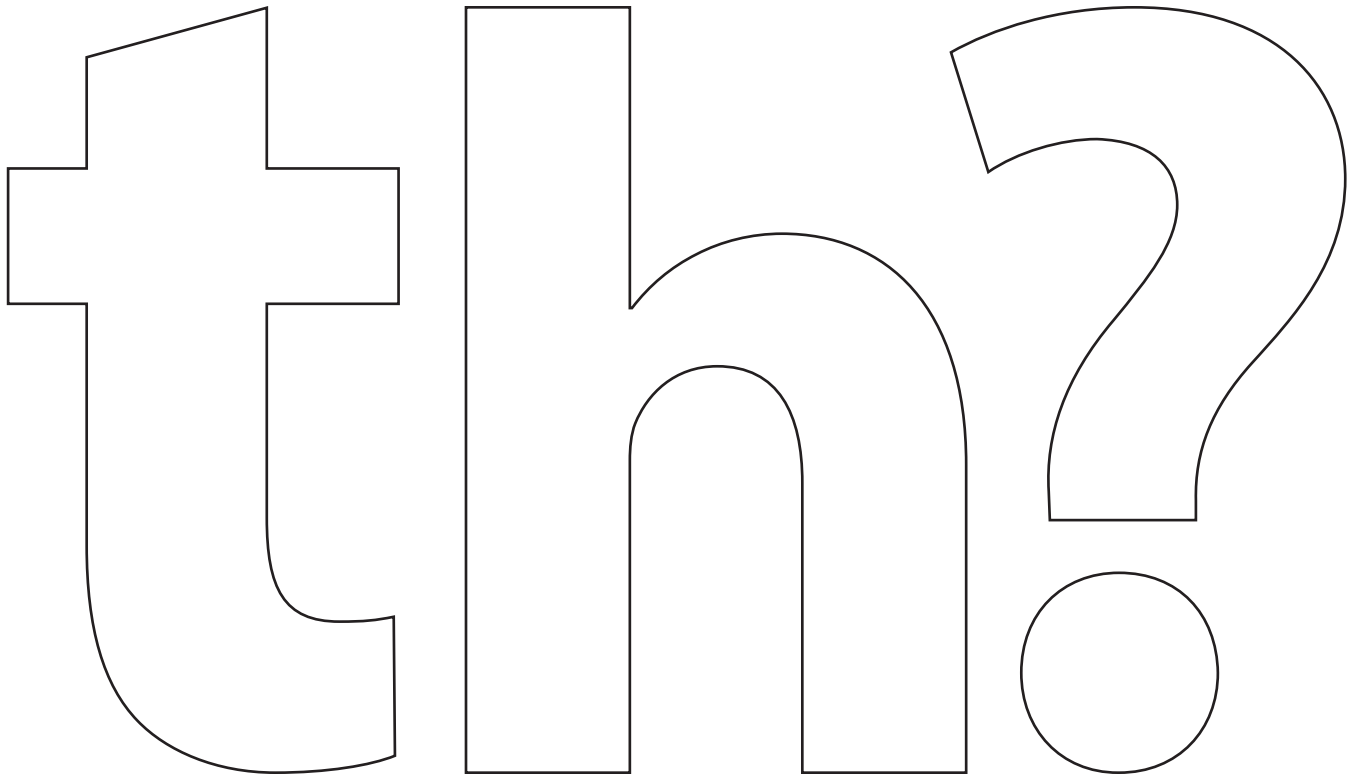

**Shown at 100% – (3" & 4" letters)**

### Resizing Guide

These letters will fit on a 2' x 3' doormat just as they are. For smaller or larger mats, just take these sheets to your local print center, and ask them to increase or decrease the size according to your needs. For example, a 3' x 5' doormat would need letters sized at about 133%.

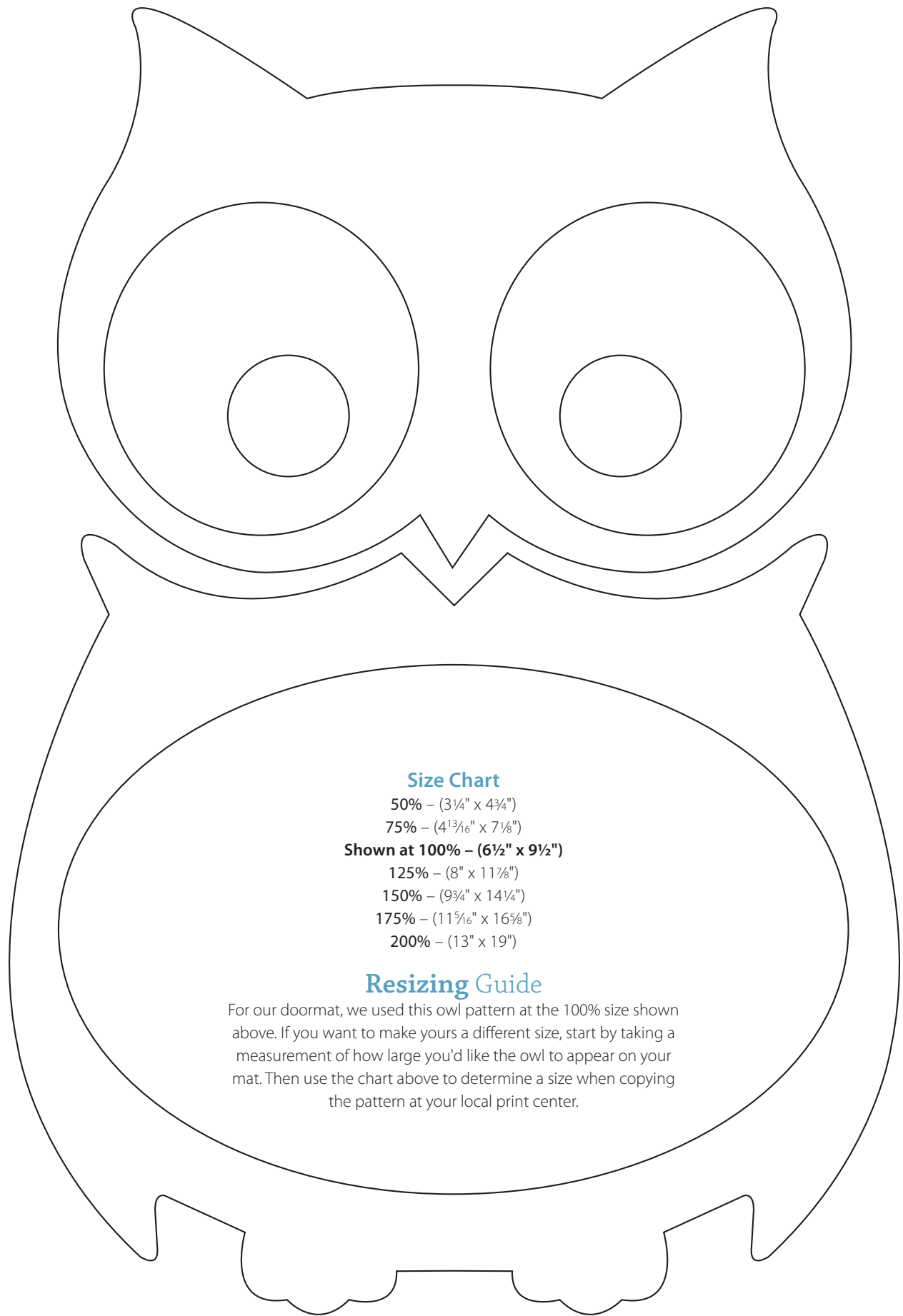

### Size Chart

50% – (3¼" x 4¾")

75% – (4<sup>1</sup>/<sub>16</sub>" x 7<sup>1</sup>/<sub>8</sub>")

**Shown at 100% – (6½" x 9½")**

125% – (8" x 11<sup>7</sup>/<sub>8</sub>")

150% – (9¾" x 14¼")

175% – (11<sup>5</sup>/<sub>16</sub>" x 16<sup>3</sup>/<sub>8</sub>")

200% – (13" x 19")

### Resizing Guide

For our doormat, we used this owl pattern at the 100% size shown above. If you want to make yours a different size, start by taking a measurement of how large you'd like the owl to appear on your mat. Then use the chart above to determine a size when copying the pattern at your local print center.

## Easy Painted Doormats

online  
extra!

On the following pages, you'll find templates and step-by-step instructions to create these doormat projects for your home. For more information about these projects, see the May/June 2011 issue of *My Home My Style*.



STEP  
BY  
step

## Simple Stripes



**1** **Protect the black edge** around the doormat by covering it with painter's tape. Press the tape down firmly to make sure it adheres to the rubber.



**2** **Lay out your striped pattern** with more strips of painter's tape. Use your fingers to press the tape into the ridges to help prevent paint seepage.

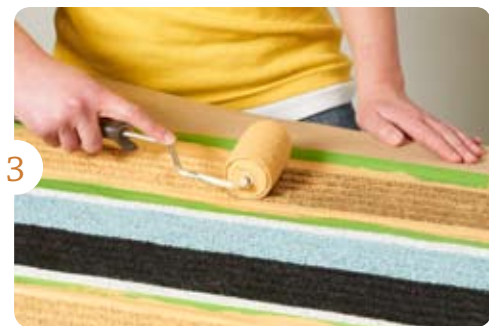

**3** **Roll two coats of exterior paint** on each stripe, with the exception of the black stripes. These are created by simply leaving the area unpainted.

## Design a Striped Doormat

Stripes are one of the simplest patterns to create on a doormat because the ribbed surface helps guide your tape placement. Start by taping off the mat's border so it will remain black (*Step 1*). Then lay out a design that has several colors of stripes in random widths (*Step 2*). Roll a light coat of paint on all stripes of the same color. Let it dry, then roll on a second coat for good coverage (*Step 3*). Move on to the next color, retaping as necessary.

## Design a Leaf-Patterned Doormat

For a fun look, try a mat with tropical leaves. It's easy using faux leaves from the craft store (or the stencil pattern on the next page). Just choose any generous-sized leaves that will fit on the doormat you're using (our leaves measured 24" long and 18" long). Then remove the "veins" from each leaf so it will be easier to paint over (*Step 1*).

A light coat of spray adhesive will ensure that the leaves stick to the doormat and help keep paint from seeping underneath them. After you've glued the leaves to the mat, use painter's tape and a sharp knife to create natural-looking stems (*Step 2*). Finally, apply paint over the entire mat, using light pressure and a lightly loaded roller (*Step 3*). You can aim for full coverage with the second coat.

STEP  
BY  
step

## Natural Beauty



**1** **Gently pull the "veins" off** of a synthetic leaf to make it easier to glue down. Then lightly spray the front of the leaf with adhesive, flip it over, and press it onto the doormat, making sure it's flat.

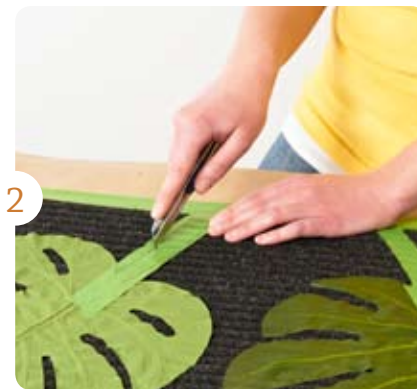

**2** **To create each leaf's stem,** place a piece of painter's tape between the leaf and the border. To give the stem realistic look, use a sharp knife to cut gentle curves on both sides of the tape.

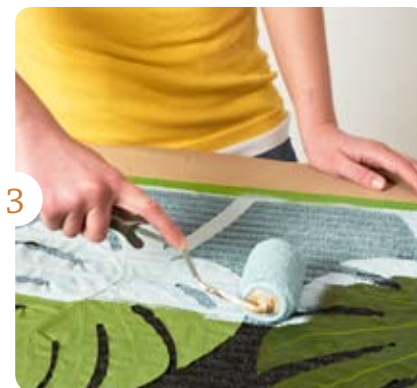

**3** **Apply a thin coat of paint** all over the mat using a small roller. Be careful not to squeeze paint under the leaves as you work. When this coat is dry, roll on a second for best coverage.

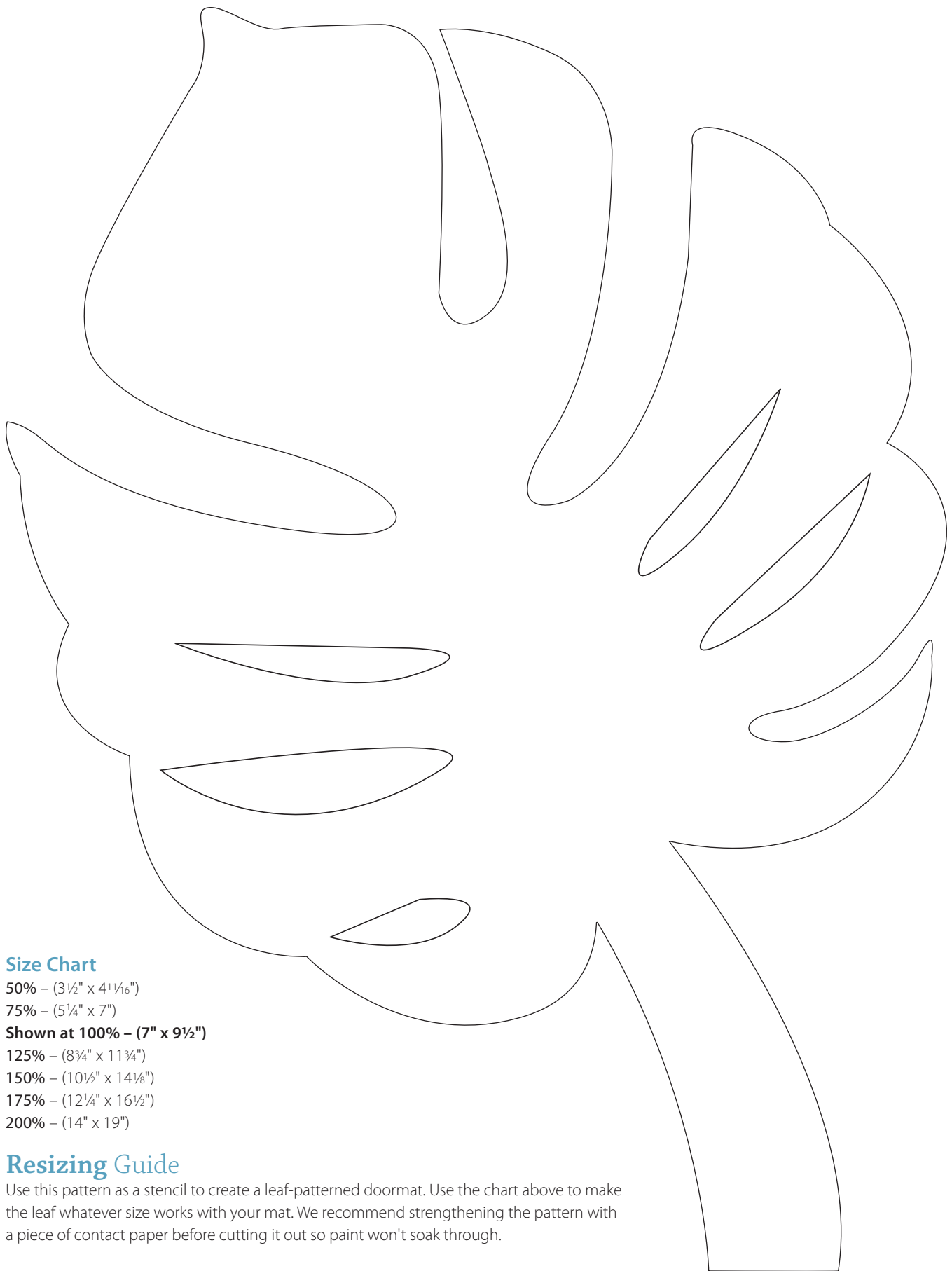

### Size Chart

50% – (3½" x 4<sup>1</sup>/<sub>16</sub>")

75% – (5¼" x 7")

**Shown at 100% – (7" x 9½")**

125% – (8¾" x 11¾")

150% – (10½" x 14<sup>1</sup>/<sub>8</sub>")

175% – (12¼" x 16½")

200% – (14" x 19")

### Resizing Guide

Use this pattern as a stencil to create a leaf-patterned doormat. Use the chart above to make the leaf whatever size works with your mat. We recommend strengthening the pattern with a piece of contact paper before cutting it out so paint won't soak through.

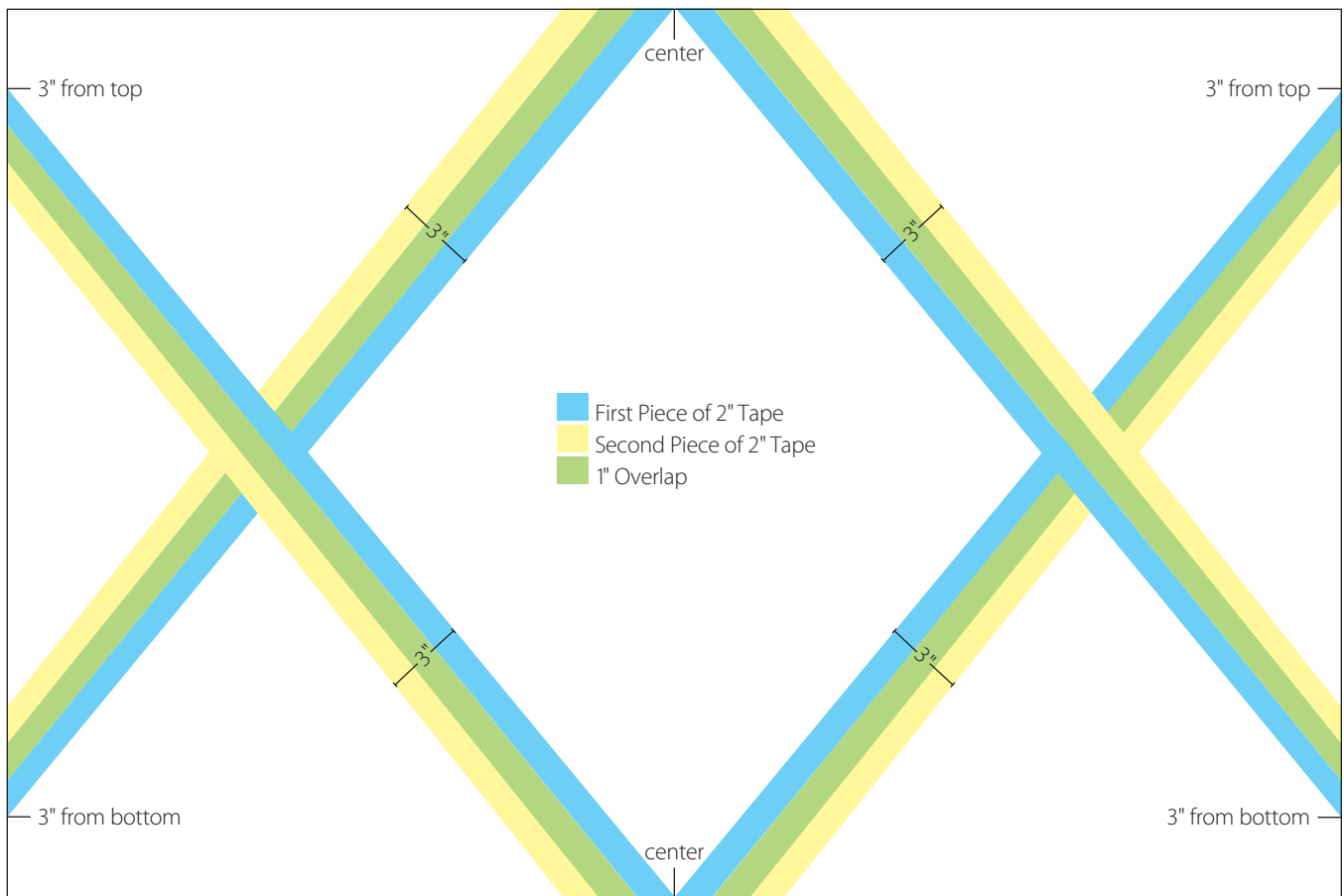

## Create a Classic Diamond Pattern

This graphically clean pattern looks great in contemporary or traditional settings. You can easily customize the mat with your home address — just pick up vinyl numbers at the home center and cut them out.

Like our other designs, this pattern can be modified to work on doormats of various sizes. Just use the measurements shown in the diagram *above* when you lay out the pattern (*Step 1*). We used 2"-wide painter's tape, but you could make the lines wider or narrower if you prefer.

To help keep the paint from seeping under the numbers, stick them down with spray adhesive. (*Step 2*). They'll still be easy to remove when you're done. Let the first light coat of paint seal the edges of the tape and numbers (*Step 3*).

### STEP BY step

## Lay Out Tape & Apply the Paint



1

**To create the black stripes,** lay strips of painter's tape on the mat according to the diagram above. Then firmly press the tape into the recesses of the ribbed surface to prevent seepage.



2

**Spray stencil adhesive** on the back of each vinyl house number, and then press them onto the doormat in the proper positions.



3

**Use a small roller to apply paint** lightly and evenly over the entire mat. After the first coat has dried, roll on a second light coat.