

Add Outdoor Style with Perfect Plants

online
extra!

On the following pages, you'll find information and planting guides for the plants we used to dress up the deck shown below. For more information about this deck makeover, see the May/June 2011 issue of *My Home My Style*.





Chenille plant
Acalypha hispida

Boston fern
Nephrolepis exaltata



Containers Plant List

- A** Scarlet sage *Salvia splendens* 'Lighthouse Red'
- B** Euphorbia *Euphorbia hypericifolia* Diamond Frost® ('Inneuphe')

- C** Boston fern *Nephrolepis exaltata*
- D** Sago palm *Cycas revoluta*
- E** Rubber plant *Ficus elastica*
- F** Spurge *Euphorbia xmartini* 'Ascot Rainbow'

- G** Purple fountain grass *Pennisetum setaceum* 'Rubrum'
- H** Variegated Swedish ivy *Plectranthus madagascariensis* 'Variegated Mint Leaf'
- I** Lantana *Lantana* 'Radiation'



check out the
May/June
 2011 issue for
 more dramatic
 deck ideas

Containers Plant List

- A** **Cordyline** *Cordyline australis*
 'Red Sensation'
- B** **Ornamental pepper**
Capsicum annuum 'Medusa'
- C** **Calibrachoa** *Calibrachoa*
 Superbells® Dreamsicle
- D** **Vinca** *Vinca minor*
 'Illumination'
- E** **Variegated sweet flag**
Acorus gramineus 'Ogon'
- F** **Lantana** *Lantana* Luscious®
 Citrus Blend™
- G** **English ivy** *Hedera helix*
 'Misty'



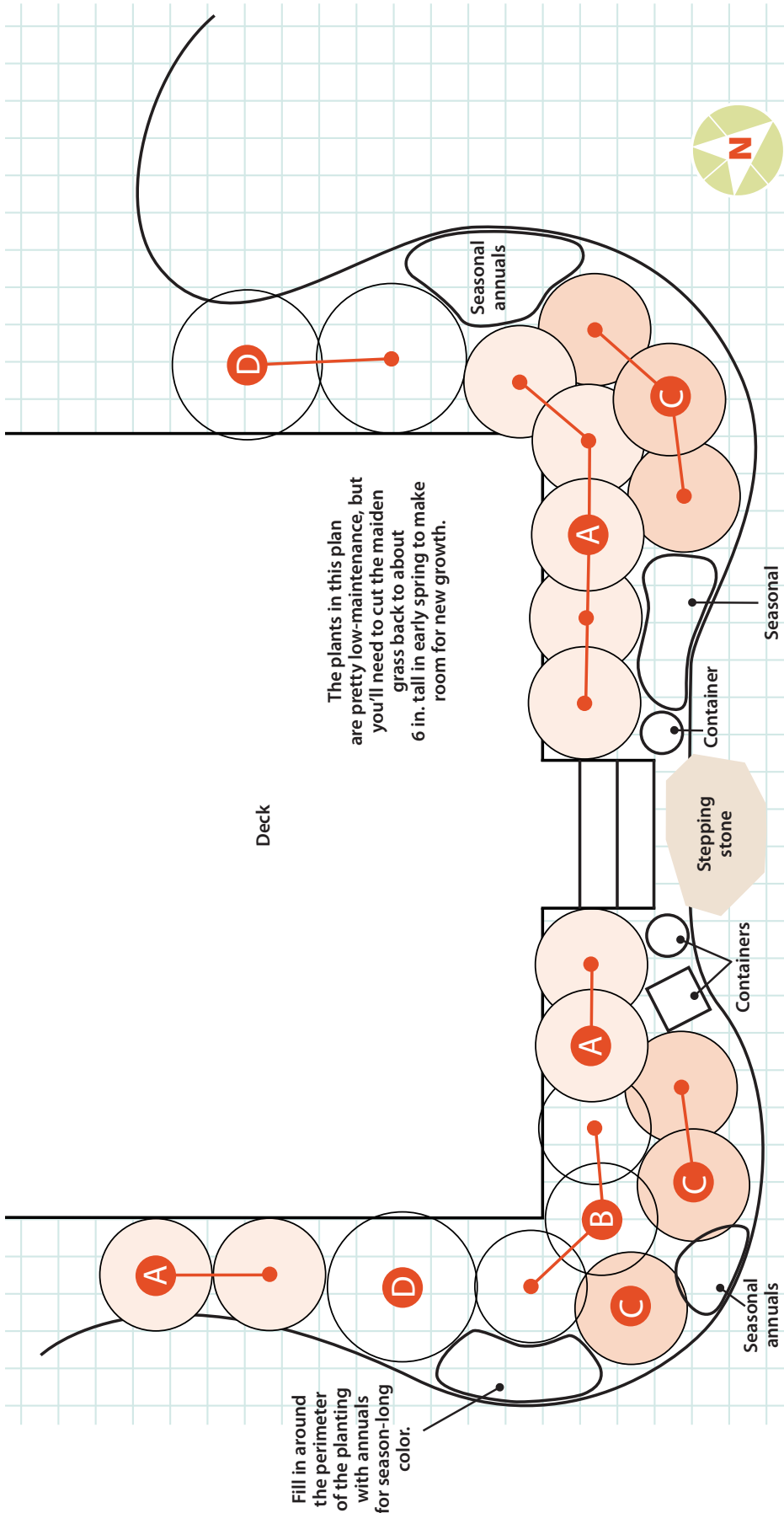

Scale: 1 square = 1 square foot

The plants in this plan are pretty low-maintenance, but you'll need to cut the maiden grass back to about 6 in. tall in early spring to make room for new growth.

Deck

Fill in around the perimeter of the planting with annuals for season-long color.

- A Maiden grass** *Miscanthus sinensis* 'Gracillimus'
Perennial; narrow leaves have white variegated stripe down center, tan fall plumes change to silver; full sun; 4 to 6 ft. tall, 3 to 5 ft. wide; cold zones 4 to 9, heat zones 9 to 1
Number to plant: 9
- B Upright juniper** *Juniperus scopulorum* 'Wichita Blue'
Evergreen shrub; can be sheared lightly to maintain upright shape; full sun; can reach 10 to 15 ft. tall and 4 to 6 ft. wide; cold zones 3 to 7, heat zones 7 to 1
Number to plant: 3
- C Japanese barberry** *Berberis thunbergii atropurpurea* 'Royal Cloak'
Shrub; burgundy foliage on arching stems; full sun; 3 to 5 ft. tall and wide; cold zones 4 to 8, heat zones 8 to 1
Number to plant: 6
- D Arctic blue leaf willow** *Salix purpurea* 'Canyon Blue'
Shrub; blue-green leaves on red-brown twigs turn yellow in fall, can be sheared to maintain shape; full sun; 4 to 5 ft. tall, 3 to 4 ft. wide; cold zones 4 to 7, heat zones 7 to 1
Number to plant: 3