

Home Storage

made simple

Compact **Corner Office**



On the following pages you'll find step-by-step instructions, photos, and illustrations that you can use to create this home office. For more information about this project, see *Home Storage Made Simple*.



create a home office

- This home office project begins with a trip to the home center where you can pick up all of the materials (see *Resources*, page 5).
- Start by making a few alterations to the cabinet before painting it. First, glue and nail a piece of $\frac{1}{4}$ " plywood to each side. This builds out the sides to make it easier to add molding to the cabinet.
- The molding just wraps around the bottom of the cabinet. It's made up of two layers of 1x4 boards, but the back boards are raised $\frac{3}{4}$ " to create a "reveal" between the two layers (*Cabinet Bottom Detail*, page 4). You can cut these boards to length and then glue and nail them in place.
- Now turn your attention to the top and desk panels, which are built similarly. Each is cut from $\frac{3}{4}$ " plywood using a circular saw. Then two pieces of edging get glued and nailed to each panel. The edging is a little different for each panel, but you can see how to do each one in the *Cabinet Top Detail* and *Desk Detail* on page 4.



- That just leaves the shelves. Each one is a 1x10 board cut to length with a piece of $\frac{3}{4}$ " x $\frac{3}{4}$ " molding glued to the underside of it.
- We also added an angled magazine shelf to our office setup. This shelf is made from plywood and has edging and a shelf rest glued and nailed to it. See how to make and mount it in the *Angled Shelf Detail* on page 4.
- With the parts assembled, you can now prime and paint them. Then you can set about installing your new office on the wall.
- To ensure the pantry cabinet's stability, secure it to the wall by driving a few $2\frac{1}{2}$ " screws through the back of the cabinet and into wall studs (*photo 1*).
- Attach the top panel by driving screws into a wall cleat (*photo 2*). The other end gets nailed to the top of the cabinet.

how it's made



1



2

add the hardware

- What really makes this compact office so simple is the hardware. It's a system of shelf standards and brackets that you usually see used in closets. The standards hang from a horizontal track fastened near the ceiling, and brackets snap onto the standards. This system holds all the parts securely and makes them easy to move around.
- To help the hardware pieces blend in with the wall, you can paint them to match your wall color.
- The shelf standards simply get mounted to a "hang track" that sits below the top panel. The brackets snap in place to accept all the shelves.
- Mount the hang track with the included screws. Hit wall studs, or use heavy-duty wall anchors if you can't (*photo 1*).



- Hang the shelf standards on the hang track (*photo 2*). Then secure them to the wall with screws at the bottom (*photo 3*)
- Snap the shelf brackets into place in the holes in the shelf standards.

They will be simple to reposition as needed (*photo 4*).

- Position the desk panel and shelves above the brackets (*photo 5*), and secure them from underneath with screws (*photo 6*).

how it's made



1



2



3



4



5



6

Cabinet Top Detail

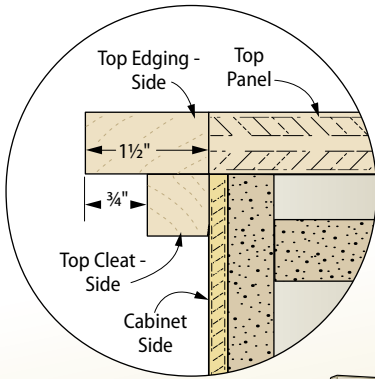

Angled Shelf Detail

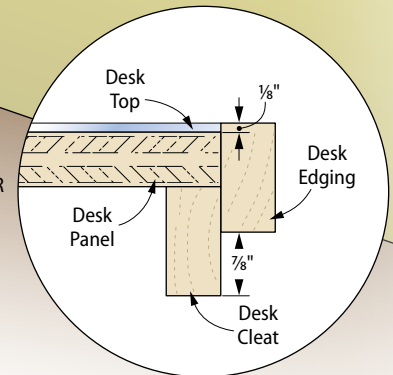
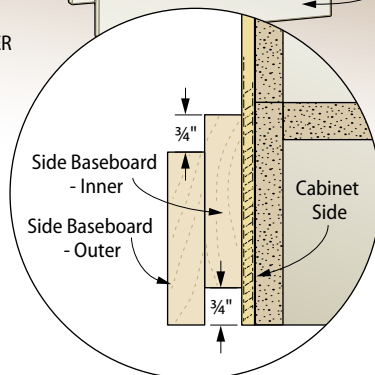
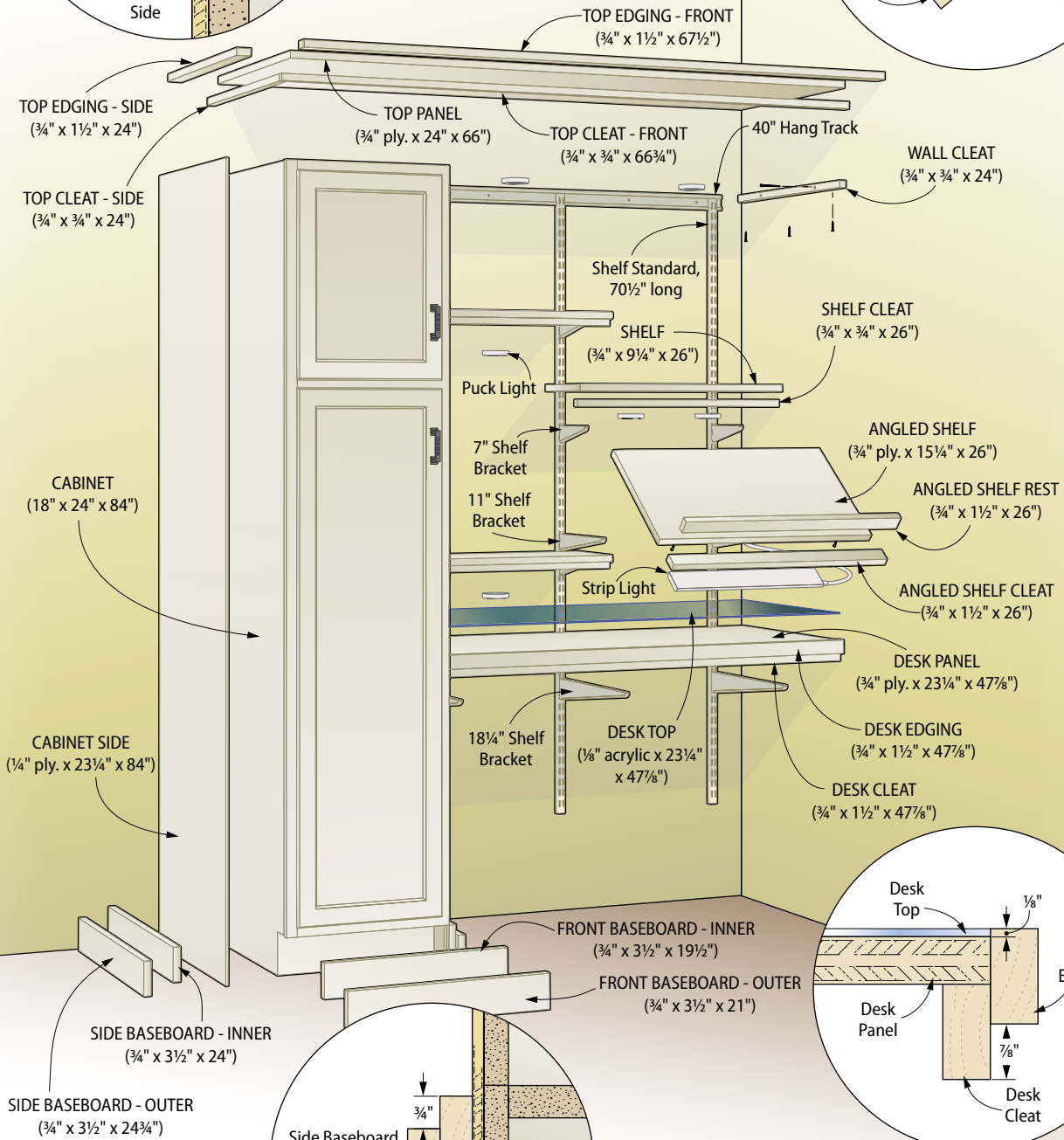
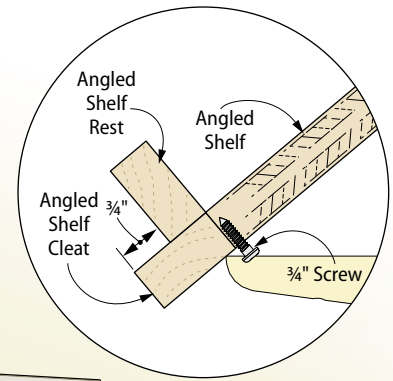

Desk Detail



Resources

Available at hardware stores and home centers.

- 18" x 24" x 84" Unfinished Pantry Cabinet
- Sheet of ¼" Plywood
- Sheet of ¾" Plywood
- (3) 8'-long 1x2 Boards
- (3) Oak ¾" Square Dowels
- (2) 8'-long 1x4 Boards
- Oak 1x10 Board
- 24" x 48" Acrylic Sheet
- 24" x 48" Sheet of Galvanized Sheet Metal
- (3) Real Organized 70½" White Double Track Standards
- Real Organized 40" White Hang Track
- (6) Real Organized 7" White Double Track Brackets
- (2) Real Organized 11" White Double Track Brackets
- (3) Real Organized 18¾" White Double Track Brackets
- 2" Finish Nails
- 1¼" Screws
- (2) Aged Bronze 3" C/C Craftsman Pulls
- (2) 22" Heavy-Duty Drawer Slides
- Rev-A-Shelf 35-qt. Double Waste Container
- (3) Utilitech 2-Light White LED Cabinet Lights
- Utilitech 5-Light 18" LED Linkable Under-Cabinet Strip